

# Elite Genverter®

## DC generators

### 24 | 48 VDC

ADJUSTABLE  
SPEED  
DC  
OUTPUT



For cases when a constant high power consumption isn't required, installing a Genverter® system with the DC PowerCube, combined with an inverter, can prove to be a smart decision. The advantage of this system is that a non-stop AC power supply is always available. This is thanks to the 4, 7 or 14 kVA AC PowerCube inverter which is connected to one or multiple onboard batteries being charged by one or several DC PowerCubes.

Whenever the 24 VDC / 48 VDC batteries need to be recharged, the Genverter® starts up automatically. At the same time, the DC PowerCube is connected to the shore power - during shore power connection, the various onboard batteries are charged with a maximum of 120 A (3.5 kW). Using the remote control panel, supplied as standard, the shore power can be set to the required ampere value (4,6,8,10,16 A). The DC PowerCube also features a charging socket for 24 VDC batteries (or 48 VDC).

|  | ELITE 2  | ELITE 3  | ELITE 3+   | ELITE 2 OUTDOOR  | ELITE 3+ OUTDOOR   |
|--|--|--|--|--|--|
| Art. Nr.                               | 49001120   | 49001320   | 49001520   | 44001120   | 44001520   |
| <b>MAIN SPECIFICATIONS</b>             |  |  |  |  |  |
| Continuous Power at 25°C (77°F)        | 4.3 kW   | 8.6 kW   | 12 kW  | 4.3 kW   | 12 kW  |
| Number of DC PowerCubes                | 1  | 2  | 3  | 1  | 3  |
| Nominal voltage                        | 24/48 VDC  | 24/48 VDC  | 24/48 VDC  | 24/48 VDC  | 24/48 VDC  |
| Charge characteristics                 | Bulk, absorption, float                                      | Bulk, absorption, float                                      | Bulk, absorption, float                                      | Bulk, absorption, float                                      | Bulk, absorption, float                                      |
| Noise level                            | 54dB(A) at 7m, 65dB(A) at 1m                                 | 54dB(A) at 7m, 65dB(A) at 1m                                 | 54dB(A) at 7m, 65dB(A) at 1m                                 | 59 dB(A) at 7m, 77 dB(A) at 1m                               | 54dB(A) at 7m, 65dB(A) at 1m (preliminary)                   |
| RPM range                              | 1500 - 3000 rpm, adjustable                                  | 1500 - 3000 rpm, adjustable                                  | 1500 - 2500 rpm, adjustable                                  | 1500 - 3000 rpm, adjustable                                  | 1500 - 2500 rpm, adjustable                                  |
| Alternator technology                  | Permanent Magnet   | Permanent Magnet   | Permanent Magnet   | Permanent Magnet   | Permanent Magnet   |
| Generator cooling                      | Liquid cooled  | Liquid cooled  | Liquid cooled  | Liquid cooled  | Liquid cooled  |
| Generator control                      | DDC  | DDC  | DDC  | DDC  | DDC  |
| Control Panel                          | DDC Local + DDC Remote                                       | DDC Local + DDC Remote                                       | DDC Local + DDC Remote                                       | DDC Local + DDC Remote                                       | DDC Local + DDC Remote                                       |
| <b>DIESEL ENGINE SPECIFICATIONS</b>    |  |  |  |  |  |
| Engine                                 | WhisperPower Kubota Z482                                     | WhisperPower Kubota D722                                     | WhisperPower Kubota D1105                                    | WhisperPower Kubota Z482                                     | WhisperPower Kubota D1105                                    |
| Displacement                           | 479 cc   | 719 cc   | 1123 cc  | 479 cc   | 1123 cc  |
| Cylinders                              | 2  | 3  | 3  | 2  | 3  |
| Bore & stroke                          | 67 x 68 mm   | 67 x 68 mm   | 78 x 78.4 mm   | 67 x 68 mm   | 67 x 68 mm   |
| Compression ratio                      | 23.5   | 23.5   | 23.5   | 23.5   | 24.0   |
| Air consumption                        | < 0.63 m³/min  | < 0.94 m³/min  | < 1.47 m³/min  | < 0.63 m³/min  | < 1.47 m³/min  |
| Cooling system                         | Radiator   | Radiator   | Radiator   | Radiator   | Radiator   |
| Fuel consumption (no load - full load) | 1.7-2.5 l/hr   | 2.6-3.8 l/hr   | 4.2-5.6 l/hr   | 1.7-2.5 l/hr   | 4.2-5.6 l/hr   |
| Starter battery charge method/ current | Alternator 12 V/12.5 A                                       | Alternator 12 V/12.5 A                                       | Alternator 12 V/12.5 A                                       | Alternator 12 V/12.5 A                                       | Alternator 12 V/12.5 A                                       |
| <b>DIMENSIONS &amp; WEIGHT</b>         |  |  |  |  |  |
| Length x width x height (cabinet)      | 660 x 550 x 622 mm   | 740 x 550 x 622 mm   | 882 x 570 x 690 mm   | 742 x 597 x 670 mm   | 741 x 907 x 736 mm   |
| Length x width x depth (DC Powercube)  | 575 x 221 x 316 mm   | 575 x 221 x 316 mm   | 575 x 221 x 316 mm   | 490 x 198 x 188 mm   | 542 x 384 x 257 mm   |
| Dry weight (cabinet + Powercube)       | 154 kg + 21 kg   | 175 kg + 2 x 21 kg   | 210 kg + 3 x 21 kg   | 200 kg + 21 kg   | 260 kg + 3 x 21 kg (preliminary)                             |
| Exhaust type                           | R 1 inch, dry  | R 1 inch, dry  | R 1.5 inch, dry  | R 1 inch, dry  | R 1.5 inch, dry  |
| Max. operating angle                   | 25° in all directions  | 25° in all directions  | 25° in all directions  | 25° in all directions  | 25° in all directions  |
| <b>OPTIONAL</b>                        |  |  |  |  |  |
|  | 2nd start/stop panel,<br>Touch panel 7"<br>Crankcase heating | 2nd start/stop panel,<br>Touch panel 7"<br>Crankcase heating | 2nd start/stop panel,<br>Touch panel 7"<br>Crankcase heating | 2nd start/stop panel,<br>Touch panel 7"<br>Crankcase heating | 2nd start/stop panel,<br>Touch panel 7"<br>Crankcase heating |

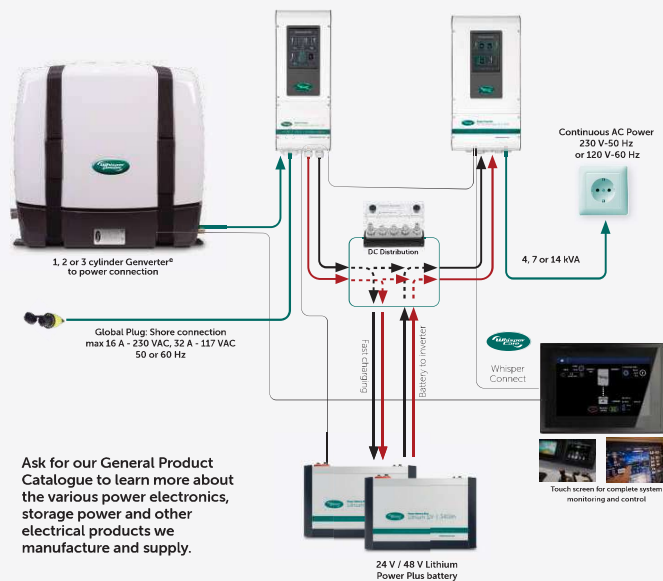

Ask for our General Product Catalogue to learn more about the various power electronics, storage power and other electrical products we manufacture and supply.

- Simple installation, no transfer switch required
- Continuous, uninterrupted clean power on board in your vehicle
- Genverter® speed adjustable and extremely quiet
- Fast charge with correct and constant engine load
- Low fuel consumption, minimal engine maintenance
- Plug-in worldwide



### Installation Dimensions

